



# SM1001p | Install Instructions For: SM1001p Powered Subwoofer

The SM1001p ships without mounting accessories.

**Optional accessories include:**

1. Surface Mount Bracket (AC-SM1001p-S)
2. Corner Mount Bracket (AC-SM1001p-C)

Mounting brackets include mounting instructions.

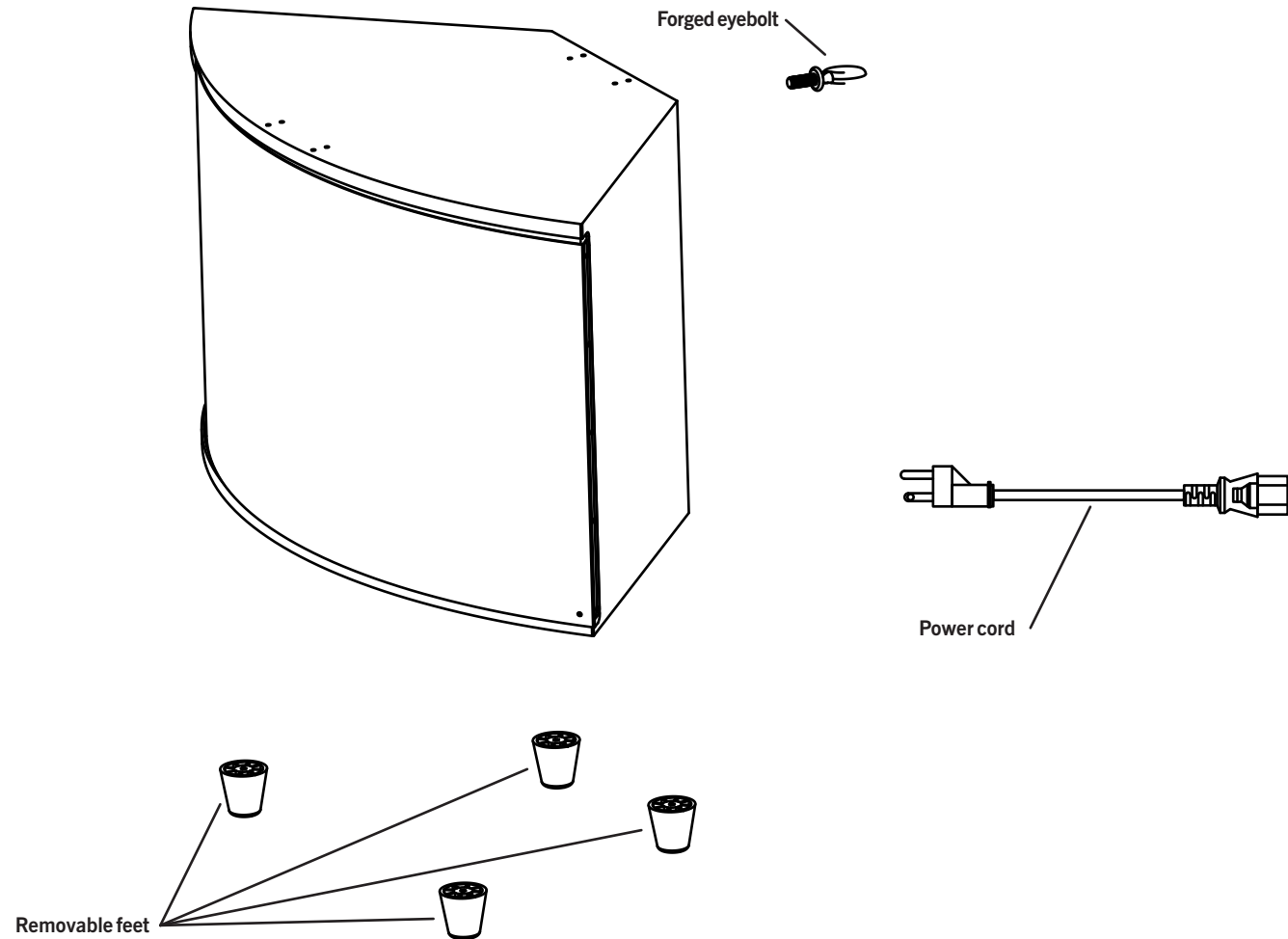

**Box contents: SM1001p**

- 1 Subwoofer
- 4 Removable feet
- 1 Power cord
- 1 Forged eyebolt
- 1 Seismic cable
- 3 Zip ties

© 2010 SoundTube Entertainment, Inc. All rights reserved. PN SM1001p Rev 07.13.10

<p><b>Warning</b></p> <p>SoundTube speakers must be installed by a professional audio installer/contractor. For safety and for optimum audio performance, installer must follow all directions issued by SoundTube Entertainment.</p>	<p><b>Warning</b></p> <p>Do not spec or install speaker near support beam, ventilation duct or other structure that may interfere with speaker function or dispersion.</p>
---	--

## SM1001p | Floor-mount Installation For: SM1001p Powered Subwoofer

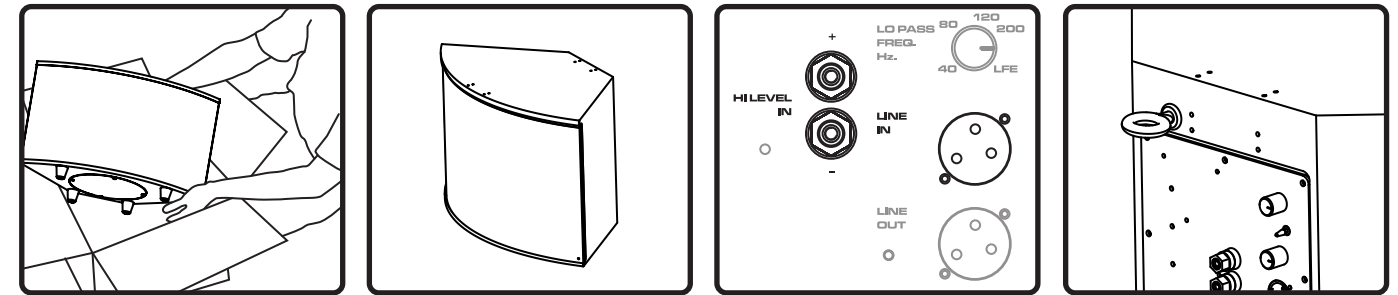

1. Unpack subwoofer.
2. Place in desired location.
3. Connect signal wire to either the balanced XLR input or the 70.7 V binding post.
4. For a safety cable attachment, screw the forged eye bolt into the 1/4-20 inserts on the back of the speaker. Attach included safety cable from forged eyebolt to secure mounting point on structure. Installer to supply structural fastener.

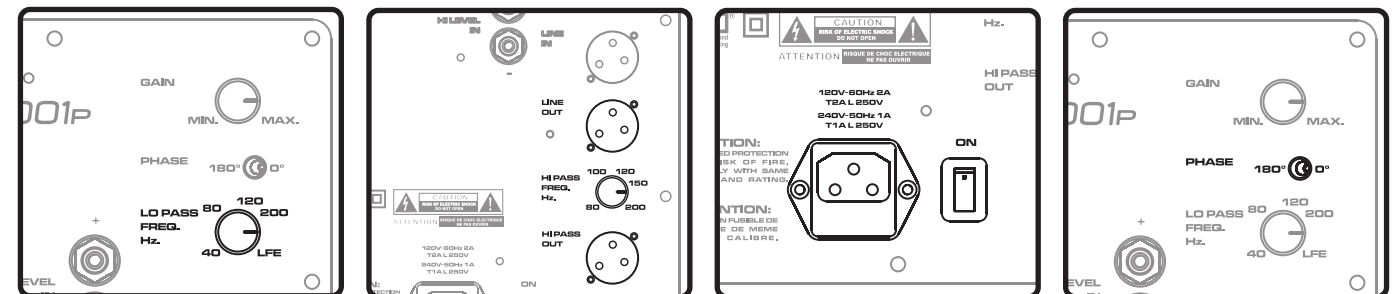

5. Set the low-pass filter with the user-adjustable knob. The low pass filter ranges from 40 Hz - 200 Hz with over-toggle to full range (LFE).
6. If signal pass-through is desired, connect the signal output to either the full range pass-through or the user-adjustable high pass output (40 Hz - 200 Hz) using the balanced XLR outputs. Note: The 70v input does not pass signal through the balanced XLR outputs.
7. Plug in the power cord, and turn the unit on. The SM1001p senses when no signal is present, and powers down to conserve energy.
8. For optimal subwoofer performance, set phase switch to either 0° or 180° (bass will be more rich when set correctly for the installation).

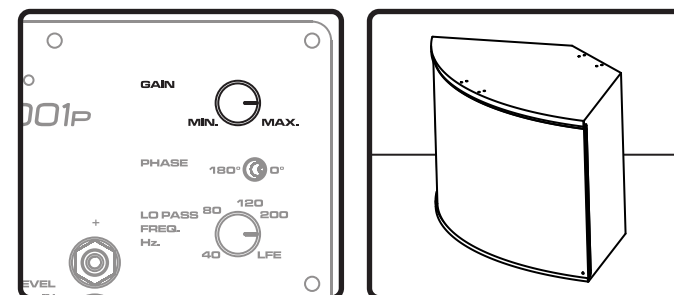

9. Set gain.
10. Done!